

# Oral Fluid Drug Screen Device

# Procedure Card

Distributed by: **CLIAwaived.com™**  
 San Diego, CA 92121  
 tel 858-481-5031  
 toll free 888-882-7739  
 www.cliawaived.com

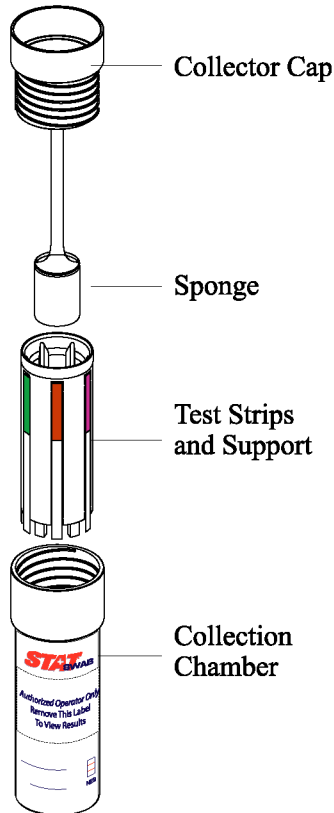

DN: WDOF02P081202V02 Part No. Y03111103

- Do not place anything in the mouth including food, drink, gum, or tobacco products for at least 10 minutes prior to collection of oral fluid specimen.

## STEP 1

- Unscrew the Collector Cap to pull out the collection stick with Sponge from the Collection Chamber.

## STEP 2

- Insert the sponge end of the collection stick into the mouth. Close mouth and actively move the sponge back and forth for saliva excretion. Gently pressing the sponge between the teeth and the tongue will assist in the sponge saturation process.

- Soak sponge into saliva in mouth and under the tongue for a total of 3 minutes until the sponge becomes completely saturated with saliva. No hard spots should be felt on the sponge when saturated.

## STEP 3

- Remove the sponge from the mouth. Place the collection stick with saturated sponge into Collection Chamber.

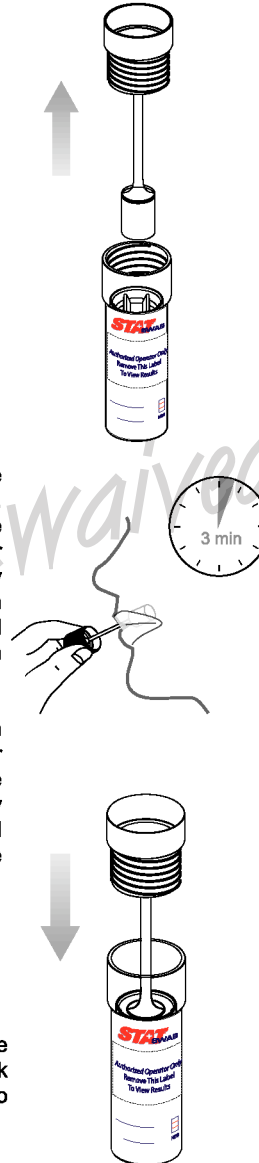

## STEP 4

- Secure the cap and start the timer.

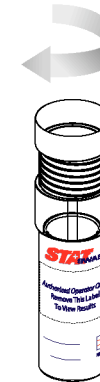

## STEP 5

- Peel off the label to read test results. Read results at 10 minutes. Do not read results after 1 hour.

